

# Wireless Microphone Package

Quick Start Guide  
 クイックスタートガイド  
 Guide de mise en route  
 Kurzanleitung  
 Guida rapida all'avvio  
 Guía de inicio rápido

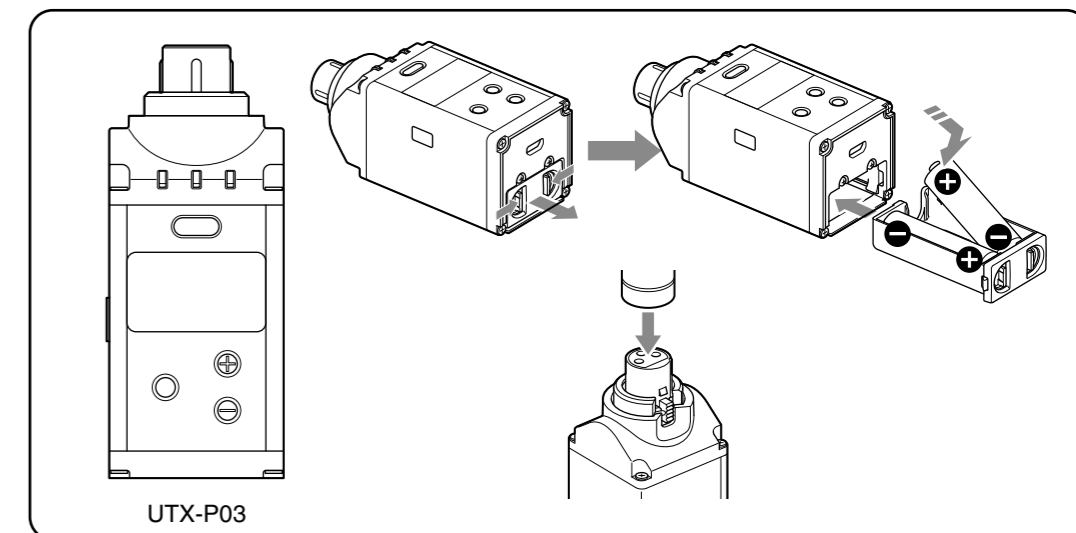
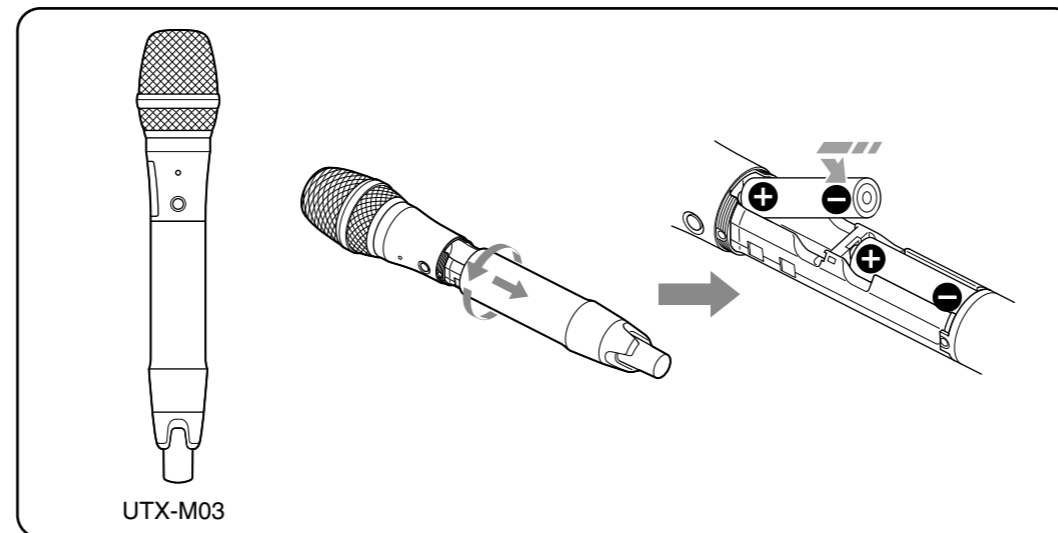
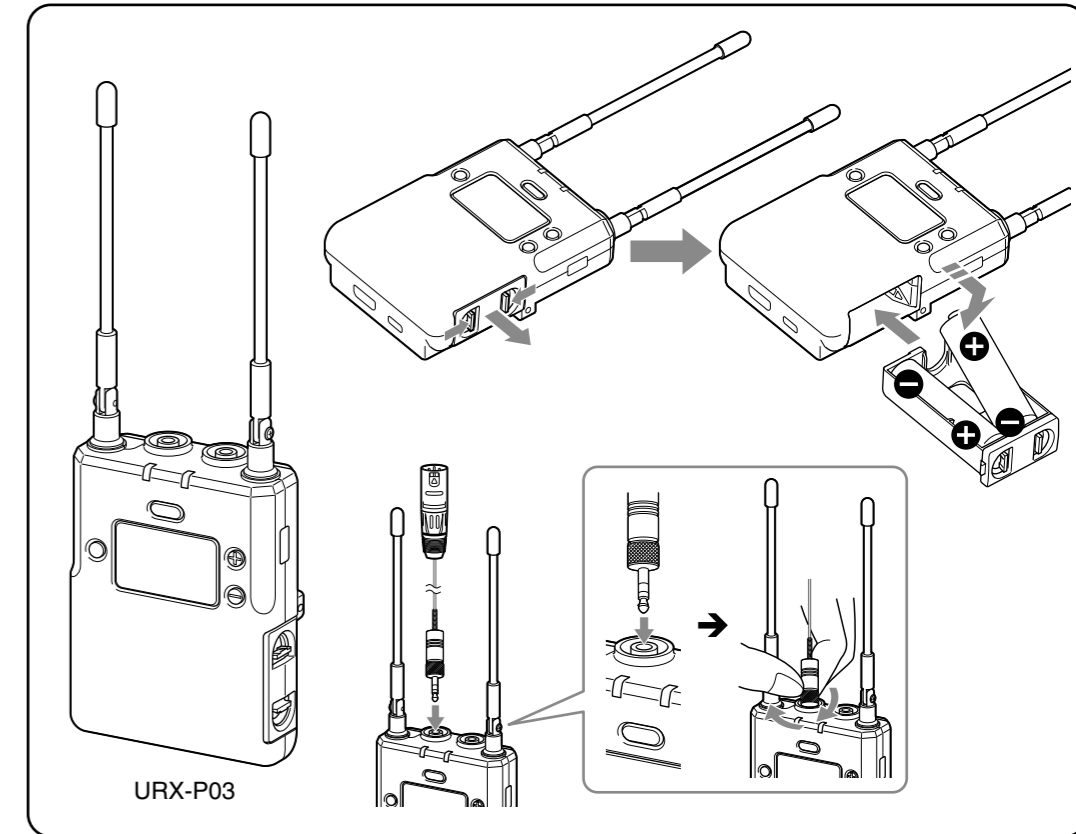
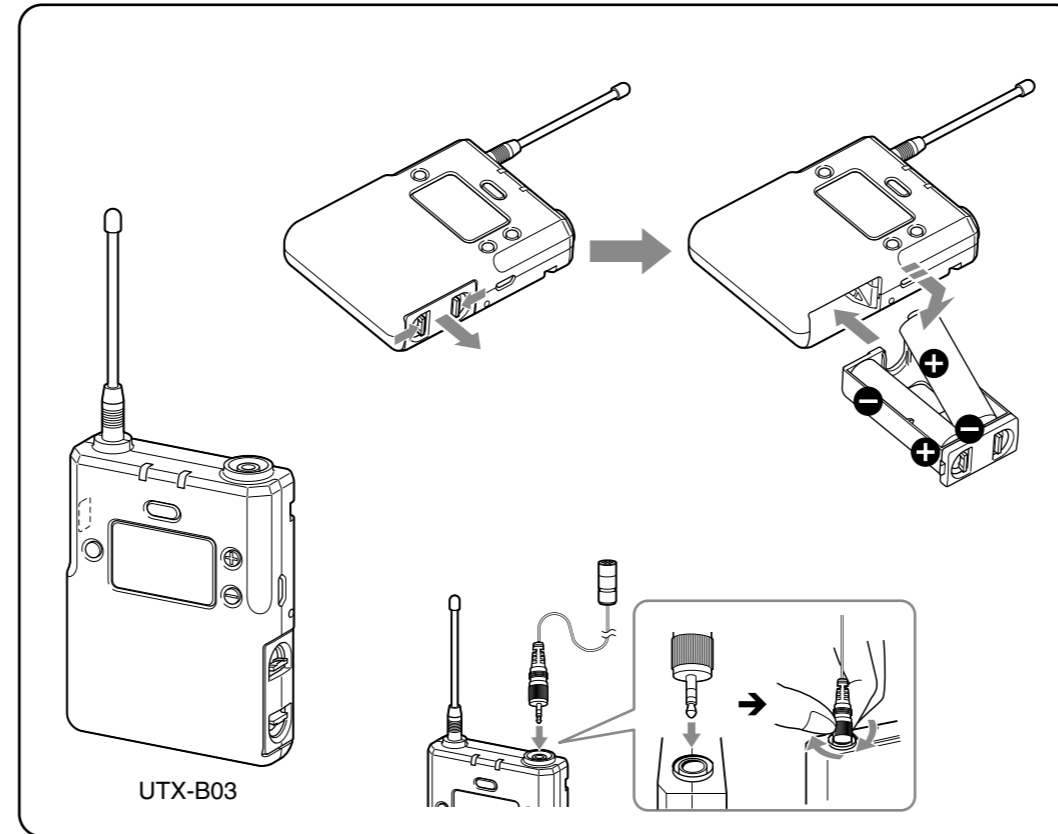

UWP-D11/D12/D16

Synchronizing the Channels / チャンネルを合わせる / Synchronisation des canaux / Synchronisieren der Kanäle / Sincronizzazione dei canali / Sincronización de canales

← : Press / 押す / Appuyer / Drücken /  
: Premere / Pulse

← : Press and hold / 長押し / Appuyer et maintenir enfoncé / Drücken und gedrückt halten /  
: Premere e mantenere premuto / Mantenga pulsado

**1** Turn on the tuner. / 受信機の電源ON /  
Mettez le tuner sous tension. / Tuner einschalten. /  
Accendere il sintonizzatore. / Encienda el sintonizador.

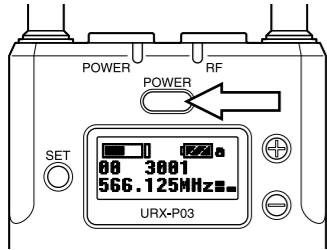

**2** Operate the tuner. / 受信機の手操作 /  
Faites fonctionner le tuner. / Tuner bedienen. /  
Utilizzare il sintonizzatore. / Ponga en marcha el sintonizador.

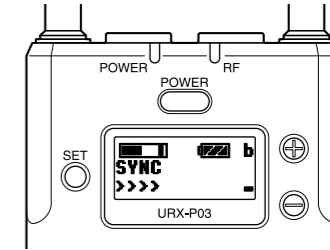
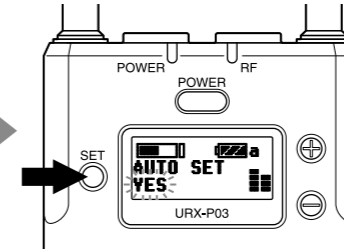
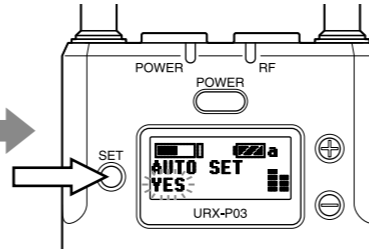
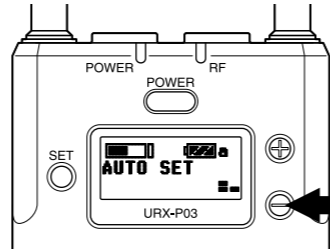
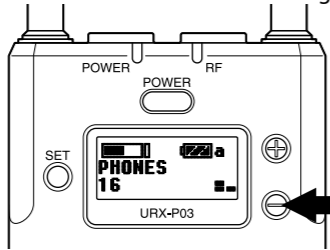

**3** Turn on the transmitter. / 送信機の電源ON /  
Mettez l'émetteur sous tension. / Sender einschalten. /  
Accendere il trasmettitore. / Encienda el transmisor.

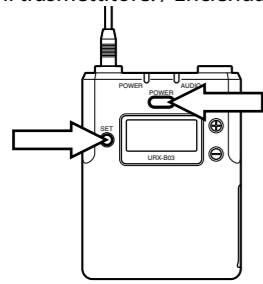

UTX-B03

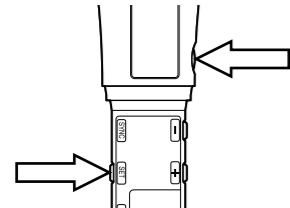

UTX-M03

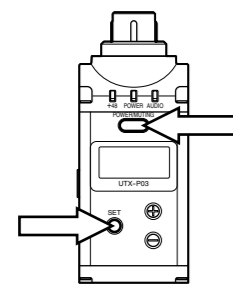

URX-P03

**4** Infrared transmission. / 赤外線通信 /  
Transmission infrarouge. / Infrarot-Übertragung. /  
Trasmisione a infrarossi. / Transmisión de infrarojos.

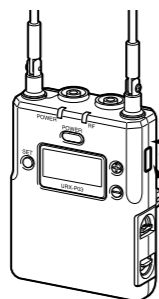

URX-P03

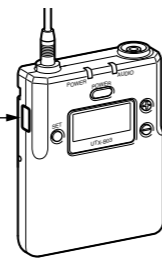

UTX-B03

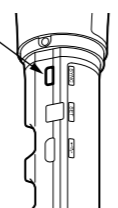

UTX-M03

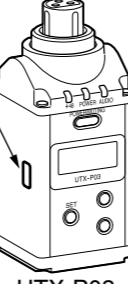

UTX-P03

Within 20 cm (8 in.) /  
20 cm以内 /  
Dans une plage de 20 cm (8 pouces) /  
Innerhalb von 20 cm /  
Entro 20 cm /  
En 20 cm

**5** Confirm channel change. / チャンネル変更の確定 /  
Confirmez le changement de canal. / Kanalwechsel bestätigen. /  
Confermare il cambiamento di canale. / Confirme el cambio de canal.

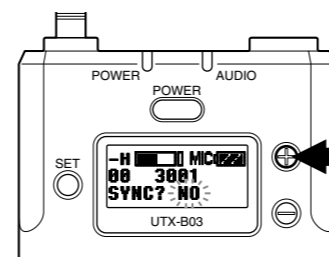

UTX-B03

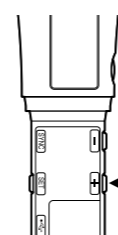

UTX-M03



UTX-P03

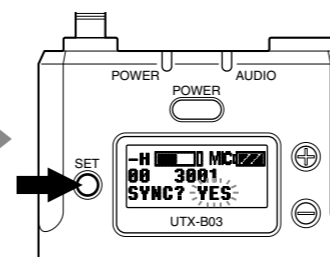

UTX-B03

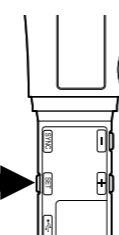

UTX-M03

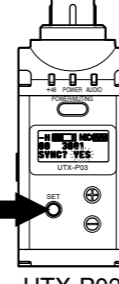

UTX-P03

- For details on operation, refer to the Operating Instructions stored on the supplied CD-ROM.
- 操作方法について詳しくは、付属のCD-ROMに収録されている取扱説明書をご覧ください。
- Pour les détails sur le fonctionnement, consultez le mode d'emploi stocké sur le CD-ROM fourni.
- Einzelheiten zur Bedienung finden Sie in der Bedienungsanleitung auf der mitgelieferten CD-ROM.
- Per informazioni dettagliate, fare riferimento alle istruzioni per l'uso contenute nel CD-ROM fornito.
- Para conocer más detalles acerca del funcionamiento, consulte el manual de instrucciones que se encuentra en el CD-ROM suministrado.